



Open Call for Mural Artists

DEADLINE EXTENDED: Sunday, June 30th, 2013

Location: Torpedo Factory Art Center, 105 N. Union Street, Alexandria, VA 22314

Description: This is an open call for artists to submit concepts to be considered for a mural that will cover the walls inside of the Torpedo Factory Art Center along the waterfront entrance (See diagram for measurements). This call is open to all local and regional artists. The winner of the selected mural will be awarded \$2,000. Our juror, Shane Pomajambo, will select the top three proposals, with final selection to be chosen by Eric Wallner, CEO of the Torpedo Factory Art Center.

Juror: Shane Pomajambo is the CEO and Creative Director of Art Whino gallery, a DC based art gallery whose mission is to bring together the freshest talent in the underground art scene, with a focus on Pop Surrealism and Low Brow art movements. He is the creative mind behind the G40 Art Summit, which in its third year in 2012 focused on the "Art of the Mural," showcasing twelve of the top mural artists from around the globe including such talents as Angry Woebos, Gaia, and Pixel Pancho. Most recently, he brought Atlanta-based artist HENSE to Washington, DC to create a full building mural covering an entire abandoned church. Pomajambo is also an architect and owner of Moderne Design, a multi-disciplinary design build firm focusing on contemporary design.

Selection Criteria: Our juror will select top three proposals based on the following:

- Work of the highest caliber and effective execution
- Mural is 100% the artists original design
- Visual impact on pedestrian traffic
- Creativity and uniqueness of mural content and technique
- Appropriateness of content (should be appropriate for all audiences)
- Experience of working on mural projects and ability to complete work within a specified timeline

Artist Eligibility: To qualify, artists just meet the following requirements:

- Must be 18 years of age or older
- Live locally in the DC-metro area (regional artists may be considered however there will be no travel/food stipend)

Selected Artist Responsibilities

- Executed work must be true to submitted concept design
- Artist must supply their own specialty equipment and materials needed including brushes and paint. (Art Center will provide ladders and drop cloths)
- Artist must be willing and able to meet all contractual obligations and adhere to a strict timeline set forth by the Torpedo Factory Art Center and agreed upon by both parties.

Use this Section for Mail-In Applications only

Thank you for your interest in the Torpedo Factory Art Center's open call for a mural to adorn the waterfront entrance of the Art Center. To apply as an artist, or as a group/collective of artists, please fill out form below. All applications must be received by Sunday, June 30th.

Artist Name (if applying as an artist group/collective please list main point of contact): _____

Email: _____

Phone: _____

Mailing Address: _____

Checklist:

Filled out and Signed Application Form

CD including:

---3-5 images of past projects

---PDF or Word Document with a short written proposal & sketches of proposed mural

Mail to: Torpedo Factory Art Center, Attn: Target Gallery, 105 N. Union Street, Alexandria, VA 22314

Selection Criteria: Our juror will select top three proposals based on the following:

- Work of the highest caliber and effective execution
- Mural is 100% the artists original design
- Visual impact on pedestrian traffic
- Creativity and uniqueness of mural content and technique
- Appropriateness of content (should be appropriate for all audiences)
- Experience of working on mural projects and ability to complete work within a specified timeline

Artist Eligibility: To qualify, artists just meet the following requirements:

- Must be 18 years of age or older
- Live locally in the DC-metro area (regional artists may be considered however there will be no travel/food stipend)

Selected Artist Responsibilities

- Executed work must be true to submitted concept design
- Artist must supply their own specialty equipment and materials needed including brushes and paint. (Art Center will provide ladders and drop cloths)
- Artist must be willing and able to meet all contractual obligations and adhere to a strict timeline set forth by the Torpedo Factory Art Center and agreed upon by both parties.

By submitting and signing this document, I agree to the above criteria:

Artist Signature: _____

Date: _____

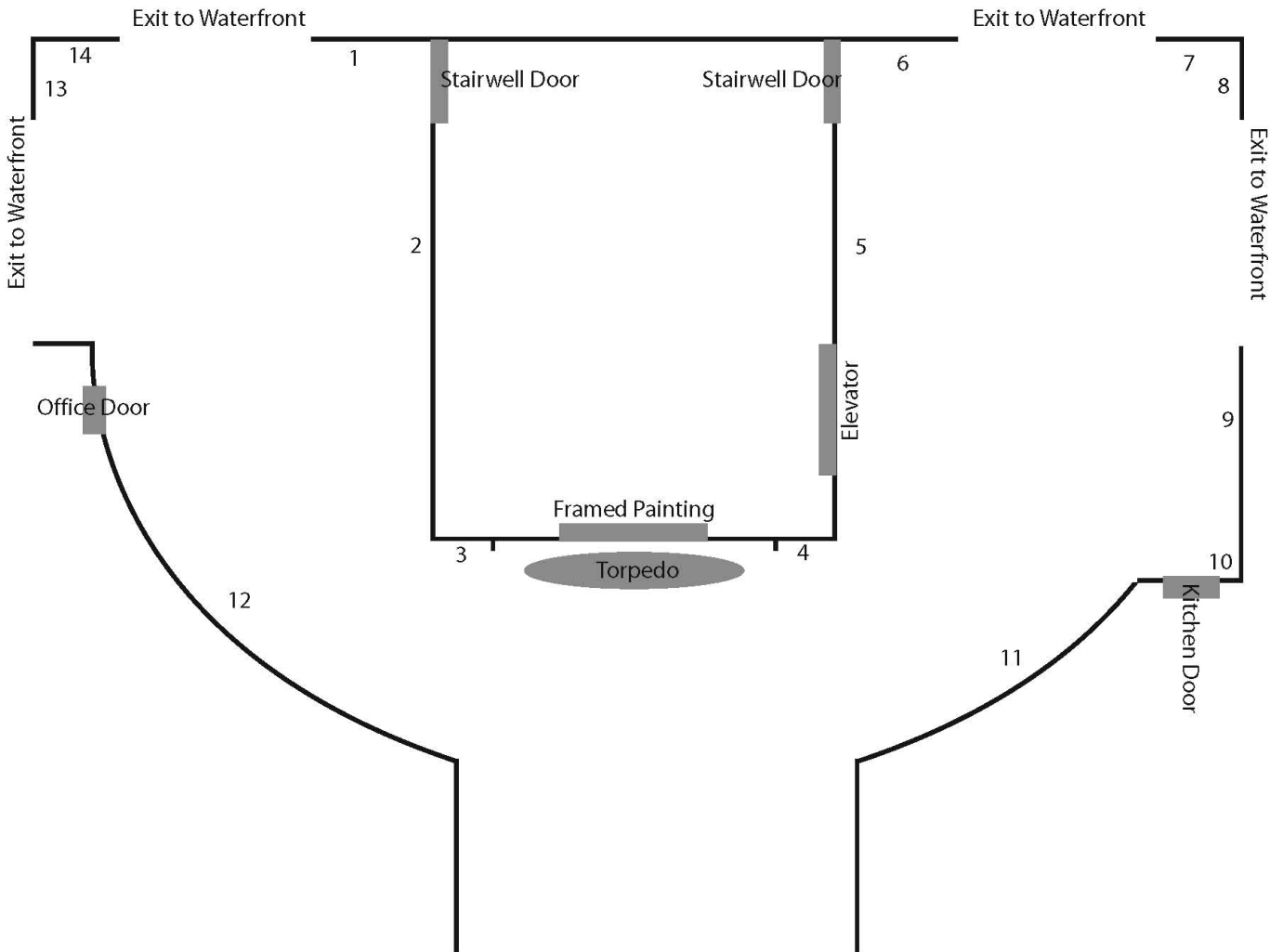

All walls are 110" tall unless otherwise noted.

1. 50" wide
2. 196" wide
3. 42" wide
4. 42: wide
5. 196" wide (elevator is 52" wide)
6. 50: wide
7. 65: wide
8. 90 wide
9. 88: wide x 35" tall (wall is between a floor cabinet & window)
10. 23" wide x 60 inches tall (wall above a floor cabinet)
11. 245" wide with a 95" chalkboard in the center
12. 265" wide
13. 75" wide
14. 60" wide